

EXHIBITOR INVITATION

IEEE Power Engineering Society

2006

PSCE



Hosted by



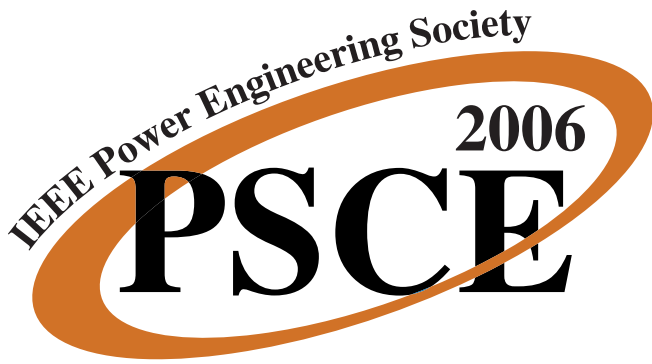

Power Systems Conference and Exposition Overview

New Solutions for New Challenges

In Power Systems Operation, Planning, Policy, Markets, Analysis, and Control

Building on the success of the 2004 inaugural meeting, the 2006 IEEE PES Power Systems Conference and Exposition promises to be a major event that will provide an exceptional venue for discussing issues and developments as well as for highlighting key vendors with products and services essential to the multifaceted field of *electrical power systems*.

PSCE will bring together an international group of power systems engineers, operators, planners, policy makers, economists, academics, and others with interest in the profession.

The conference will begin with a timely and valuable plenary session and will also include tutorials on the most up-to-date topics on *power systems*. In addition, the conference will comprise an outstanding combination of technical papers and panel sessions focusing on the following tracks:

- Track 1: Planning and Operation
- Track 2: Markets, Policies, and Economics
- Track 3: Dynamic Performance of Power Systems
- Track 4: Real-Time Applications
- Track 5: Education-Understanding Power Systems

The Exposition - A Highlight of the Event: The exposition will feature up to 80 exhibitors that will showcase state-of-the-art software and hardware systems as well as consulting services for those involved with *power systems*. The conference will feature several scheduled times devoted exclusively to the exhibits - with no parallel technical sessions - so attendees can focus on the displays and have a chance to speak directly with vendors about the latest technologies.

Building on Our Success: Recap of PSCE 2004 and Looking Ahead to PSCE 2006

Attendance

- 2004 Target: 400 - 500 delegates
- 2004 Actual: 930 in all registration categories
- **2006 Projected attendance: More than 1000** engineers, operators, planners, policy makers, economists, academics, and others in the field

Exposition

- 2004 Target: 30 8'x10' booths
- 2004 Actual: 52 booths featuring 44 exhibitors (20 companies could not be accommodated due to space limits)
- **2006 Projected Exposition: 80 8'x10' booths**

Technical Papers

- 2004 Target: 200 papers
- 2004 Actual: 350 papers
- **2006 Projected submissions: 500 papers**

Space is limited! The inaugural exposition in 2004 sold out early! For more information on your company's opportunities to exhibit at PSCE 2006, access the meeting website at www.pscexpo.com

Hosted by:



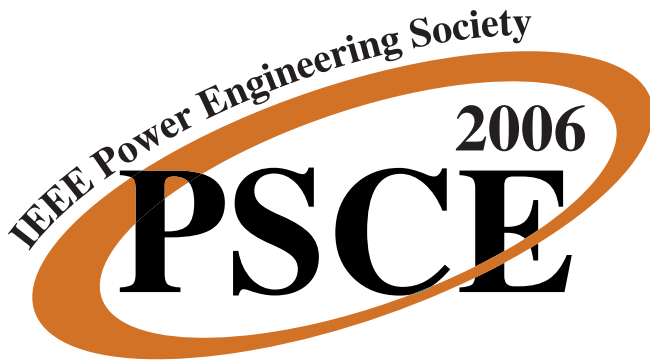

Exhibitor's Invitation

Be part of the IEEE PES Power Systems Conference and Exposition

PSCE will be held at the Marriott Marquis Hotel in downtown Atlanta, Georgia, on October 29 - November 1, 2006. Over 1000 professionals in the field of electrical power systems engineering are expected to attend the event. Take advantage of this excellent opportunity to meet face to face with a large group of professionals who have the buying power and influence to affect your business.

Features and Benefits of Participating in PSCE

Optimal Exposure

- Exhibits strategically located adjacent to the main conference activities

Exhibit-Only Hours

- Time slots devoted exclusively to exhibits - no competing sessions

One-On-One Networking

- Meet conference attendees at two receptions - Sunday, October 29 and Monday, October 30, 2006 (Monday's reception will be in the exhibit hall), and at a buffet lunch in the exhibit hall on Tuesday, October 31

Name Recognition

- Your company name and booth location listed in the program, and on the conference website with a link to your company's site

Don't Miss Your Opportunity: Become an Official PSCE 2006 Supporter!

- Your company will be featured on the conference website with a link to your company's site from the moment you become a supporter, acknowledged in the printed program, and highlighted by on-site signage for as little as \$750. See the SUPPORT OPPORTUNITIES page for more information and sign-up details.

Exhibit Hours (Tentative):

Monday, October 30, 2006	12:00 noon - 7:00 pm (<i>Reception in the exhibit hall 5:00 - 7:00 pm</i>)
<i>*Dedicated Hours</i>	<i>12:00 noon - 2:00 pm</i>
Tuesday, October 31, 2006	10:00 am - 4:00 pm
<i>*Dedicated Hours</i>	<i>12:00 noon - 2:00 pm (Buffet luncheon provided in the exhibit hall)</i>
Wednesday, November 1, 2006	10:00 am - 2:00 pm
<i>*Dedicated Hours</i>	<i>12:00 noon - 2:00 pm</i>

**Time devoted exclusively to exhibits.*

Book your booths early to be eligible for a discount. **The PSCE 2004 exhibit hall sold out early.** Booth selection is prioritized based on when you sign up (see preliminary floor plan attached). Send your application and inquiries to the attention of Christopher Garza at:

PSCE 2006 Exhibits • Conference Management Services, Inc.
3833 Texas Avenue South, Suite 221 • Bryan, Texas 77802-4015 USA
(979) 846-6800 (phone) • (979) 846-6900 (fax) • exhibits@pscexpo.com
www.pscexpo.com



2006 IEEE PES Power Systems Conference and Exposition

Exhibitor Prospectus

Organizations are invited to exhibit at the 2006 IEEE PES Power Systems Conference and Exposition (PSCE) October 29 - November 1, 2006 at the Marriott Marquis Hotel in Atlanta, Georgia. It is expected that over 1000 participants will join in the combined technical program and exposition, as well as other special events. The exhibit area is conveniently located with respect to the main traffic flow of the conference activities, and will accommodate 82 booths.

Conference Dates:

October 29 - November 1, 2006

Exposition Dates:

October 30 - November 1, 2006

Expected Number of Delegates:

Over 1000 engineers, operators, planners, policy makers, economists, academics, and others with interest in the profession

Exposition Location:

Marriott Marquis Hotel
Atlanta, Georgia

Booth Pricing:

Early Registration (by June 2, 2006):

\$1,350 USD per Standard booth

\$1,450 USD per Premium booth

Regular Registration (after June 2, 2006):

\$1,650 USD per Standard booth

\$1,750 USD per Premium booth

Please inquire about multi-booth discounts.

Exhibit Booth Specifications:

10 feet wide by 8 feet deep; 8 foot tall back and three foot tall sides; pipe and drape

Each exhibitor will be provided a display booth, basic electrical service, an identification sign, a skirted table with two chairs, daily aisle cleaning, nightly security, and one complimentary copy of the PSCE 2006 Proceedings on CD-ROM. Each exhibitor will also be provided: up to 4 complimentary Exhibit-Hall passes per paid booth for use by the Exhibitors' employees; 25% discount on additional exhibit hall passes or 25% discount for one-day conference registration are available for up to 4 additional employees.

General inquiries and exhibitor registration should be directed to:

**PSCE 2006 Exhibits
Conference Management Services, Inc.**

Attn: Christopher Garza

3833 Texas Avenue South, Suite 221

Bryan, Texas 77802-4015 USA

(979) 846-6800 (phone)

(979) 846-6900 (fax)

exhibits@psceexpo.com

www.psceexpo.com

www.ieee.org/power

**Exhibit Hall
 Floor Plan**

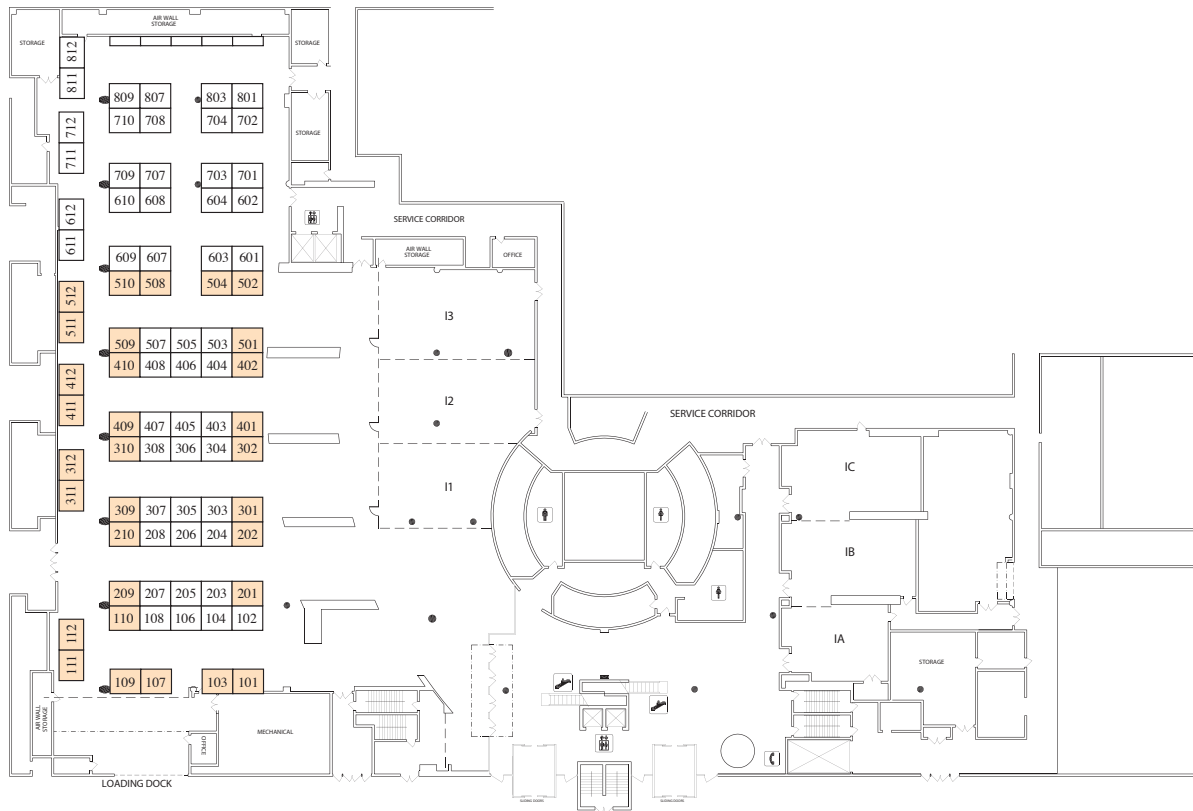

Exhibit Hours (Tentative):

Monday, October 30, 2006	12:00 noon - 7:00 pm
<i>*Dedicated Hours</i>	12:00 noon - 2:00 pm (Reception in the exhibit hall 5:00 - 7:00 pm)
Tuesday, October 31, 2006	10:00 am - 4:00 pm
<i>*Dedicated Hours</i>	12:00 noon - 2:00 pm (Buffet luncheon provided in the exhibit hall)
Wednesday, November 1, 2006	10:00 am - 2:00 pm
<i>*Dedicated Hours</i>	12:00 noon - 2:00 pm

**Time devoted exclusively to exhibits.*

Move In:

Sunday, October 29, 2006	available upon request
Monday, October 30, 2006	6:00 am - 11:00 am

Move Out:

Wednesday, November 1, 2006	2:00 pm - 5:00 pm
-----------------------------	-------------------

Premium Booths

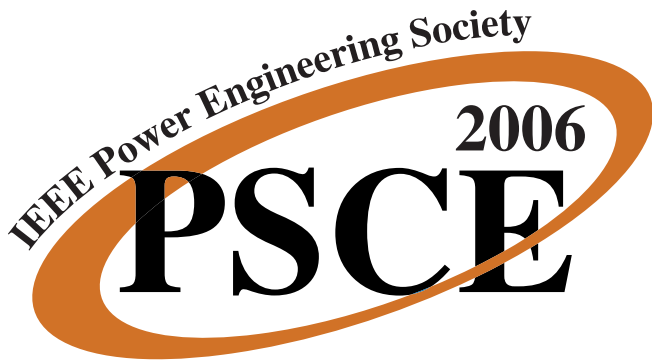

Exhibit Space Agreement

We hereby apply for exhibit space at PSCE 2006. In making an application, we agree to exhibit under and comply with the accompanying Rules and Regulations printed under this agreement and with the Rules and Regulations in any subsequent Exhibitor Bulletin, which are hereby made a part of this contract. **IMPORTANT: Closing Date for discounted Rate and Initial Space Assignment is June 2, 2006.**

Each company participating in the exhibit must return this agreement, properly executed by an authorized company representative. Priority and booth selection space will be made according to application date, exhibit payment, individual applicant requirements and available space. Exhibit Management reserves the right to rearrange the floor plan and/or relocate exhibitors in the best interests of the total exhibit.

Company Name _____

Address _____

City/State/Postal Code/Country _____

Phone _____ Fax _____

Please address further correspondence to _____

Phone _____ Email _____

We will exhibit the following kinds of products _____

Please reserve ___ booths at the **Early / Regular** rate. Booth numbers requested (in order of preference): _____

A 50% deposit must be submitted with this application; the balance is due by June 2, 2006. Checks should be made payable to IEEE / PSCE 2006, Federal Tax ID Number 13-1656633. **NOTE:** Any booth application received without the deposit is subject to reposition in the Seniority Assignment listing maintained by Exhibit Management.

The Exhibitor indemnifies and agrees to hold harmless the IEEE (PSCE 2006) Conference and the Marriott Marquis Hotel and their officers, directors, employees and agents, from and against any actions, losses, costs, damages, claims and expenses, including legal fees, arising from any damage to property or bodily injury to exhibitor, exhibitor's agents, representatives, employees or contractors by reason of the exhibitor's occupancy or use of the exhibit facilities.

Approved by _____ Date _____

Title _____ Company _____

Phone _____ Email _____

PSCE 2006 Signature _____ Date _____

Credit Card Number for Booth Fees (Visa / MasterCard / AmericanExpress) _____

Exp MM / YY _____

Amount to Charge \$USD _____ Name on Card _____

Signature _____

Return this application with payment to:

**PSCE 2006 Exhibits
Conference Management Services, Inc.
Attn: Christopher Garza
3833 Texas Avenue South, Suite 221
Bryan, Texas 77802-4015 USA
(979) 846-6800 (phone)
(979) 846-6900 (fax)
exhibits@pscexpo.com**

EXHIBITOR BASIC TERMS & CONDITIONS

1. Display space will be assigned by the Conference in accordance with the conditions outlined in the DISPLAY SPACE ASSIGNMENT which forms part of this agreement. In the event of a duplicate application for the same space, the assignment priorities stated in the EXHIBIT RULES shall be used.
2. The Exhibitor shall remit with this agreement 100% of the total booth rental, as determined elsewhere in this agreement.
3. In the event of cancellation of this agreement by the Exhibitor prior to the date of the conference, the Conference will assess a cancellation charge according to the following schedule:

Cancellation on or before June 2, 2006	50% of booth rental
Cancellation after June 2, 2006	100% of booth rental

The Conference reserves the right to reassign space, withstanding the cancellation fee.

4. In the event the Conference does not accept this agreement, the Exhibitor will be promptly notified, and the fees returned.
5. The Exhibitor agrees to accept from the Conference, billing for any charges rendered during the conference in conjunction with services performed or administered by the Conference and requested by the Exhibitor. These charges may include, but are not limited to, surcharges for materials or services requested by the Exhibitor through the Conference. All such charges are due and payable in full within thirty (30) days of receipt of an invoice from the Conference.
6. The Exhibitor agrees that the Conference or its sponsor(s) shall not be liable for any damages, whether to person or property, for any reason whatsoever by reason of use, occupation, or enjoyment of the space by the Exhibitor or any person therein with the consent of the Exhibitor, and that the Exhibitor shall indemnify and keep harmless the Conference and its sponsor(s) from all liability on account of such damage or injury, regardless of cause, by the Exhibitor, its representatives, agents, or contractors.
7. In the event the site of the conference shall, in the sole discretion of the Conference, be unfit for occupancy or substantially interfered with by reason of any cause(s) not within the control of the Conference, this agreement may be terminated by the Conference. "Cause" or "causes" may include, but shall not be limited to: fire, flood, epidemic, earthquake, explosion, accident, blockage, embargo, weather, governmental restraint or orders of restraint from local or national civil or military authorities, act of public enemy, riot or civil disturbance, inability to secure appropriate labor, impairment of transportation or facilities, or inability to obtain, for whatever reason, necessary supplies, equipment, or clearances, or by rule of federal or local law, or any circumstances deemed as act of God. Should the Conference terminate this agreement pursuant to the provisions of this section, the Exhibitor waives any and all claims for damage arising therefrom. The Exhibitor further agrees that the Conference liability is limited to a refund of monies paid prior to the termination. Should the conference be underway, the Exhibitor shall expect the Conference to adjust the refund to reflect a pro rata adjustment based on the number of hours the conference shall have been in operation prior to the termination. This provision shall not relieve the Exhibitor of any liability arising from the provisions of Section 6 above, and all monies due to the Conference in regard shall be paid notwithstanding.

EXHIBIT RULES

These rules and regulations are supplemental to the EXHIBITOR BASIC TERMS AND AGREEMENTS, and they have been established for the protection of everyone. (The word "management" as used herein shall mean officers, committee members, or employees acting with authority from PSCE 2006).

1. BOOTH IDENTIFICATION

Absolutely NO company identification may be placed outside the area of the booth. No identification may be placed on posts or pillars adjacent to booths occupied by exhibitors, or on carpeted areas of the aisles beyond the standard booth limits.

2. DISTRIBUTION OF SOUVENIRS AND SAMPLES

To achieve greater exposure and attention exhibitors may donate items to be given away in a daily door prize drawing if one is established by the conference management. Souvenirs or samples which have no resale or negotiable value may also be given away. Any distribution must be conducted within the exhibitor's designated booth space. In all cases, exhibitors planning giveaways of any nature should make arrangement well in advance with the show management, which reserves the right to prohibit the distribution of anything which, in its opinion, is not in keeping with the character of the conference.

3. DISPLAY REQUIREMENTS AND RESTRICTIONS

All displays or exhibited materials must be fireproof to conform to local fire regulations. Displays must be self-supporting and nails or screw are not permitted in building floors or walls. Displays must be wholly confined within exhibitor's booth and must not obstruct the clear view of nearby exits or other exhibits.

ALL WIRING ON BOOTHS OR DISPLAY FIXTURES MUST CONFORM TO LOCAL ELECTRICAL AND LOCAL FIRE DEPARTMENT REGULATIONS.

The side of any display cabinet or structure facing a side aisle, or adjacent exhibitor's booth, must be finished or suitably decorated at the expense of the exhibitor erecting or installing such display.

No exhibit may exceed eight feet high and that only within the area extending three feet from the back wall. Maximum height of the displays in the balance of the area is four feet, except that products to stand on the floor may extend higher than this limit, but must be positioned as close to the back wall as possible, to avoid blocking the view of adjoining exhibitors.

NOTE PARTICULARLY THAT NO PART OF A SIGN OR SOLID DISPLAY MAY EXTEND HIGHER THAN EIGHT FEET ABOVE THE FLOOR.

NOTE: ANY DISPLAYS NOT CONFORMING TO THE EXHIBIT SPECIFICATIONS OUTLINED IN THESE RULES MUST BE APPROVED BY THE CONFERENCE MANAGEMENT IN WRITING PRIOR TO THE MOVE-IN DATE.

4. BOOTH PERSONNEL & ACTIVITIES

With the exception of convenience help, such as secretaries or professional product demonstrators, all booth personnel must be REGULAR EMPLOYEES of the company, or its representatives, who are fully capable of explaining the technical aspects of products or processes on display on an appropriate level at the conference.

No exhibitor may advertise or promote any outside activity, such as an open house or separate exhibits wherever located, occurring during the hours PSCE 2006 exhibits are open, or which detracts from the exhibit or convention operations.

Only registered exhibitors may publicly advertise hospitality rooms and only on those bulletin boards provided in the exhibit area.

5. LIABILITY AND THEFT

Show and hotel management will not be responsible nor liable for injury to the person or property, nor loss of property of exhibitors, their guests, invitees, employees, or agents. Furthermore, the exhibitor agrees to defend or hold harmless the conference, its directors, employees, and agents from any liability of personal injury and loss or damage to property. EXHIBITORS SHOULD INSURE AGAINST SUCH CONTINGENCIES. Damage to inadequately packed property is exhibitor's own responsibility. If exhibit fails to arrive, exhibitor is nevertheless responsible for the booth rental.

Exhibitors should be on hand to supervise during set-up and dismantling of products, projection equipment and other items of high value. At least one person should remain with the exhibit until visitors have left the premises at the closing hour each day.

At move-out, specific arrangement should be made to package or place under lock any items of extremely high value and especially items of general interest such as small instruments, walkie-talkies, high fidelity equipment, projectors, etc.

6. SUB-LETTING EXHIBIT SPACE

No exhibitor may assign, sublet or apportion any of the space contracted for by him/her or their company.

7. MATERIALS HANDLING

The handling of exhibitor's material into and out of and within the exhibit buildings shall be at exhibitor's expense. Exhibitor's empty crates, boxes and cartons will be removed from the show area before the opening.

8. A security guard, supplied by the conference, will prevent entry to exhibit areas by anyone not authorized by PSCE 2006 management, or not wearing proper badge for admission to such areas. A WATCHMAN SERVICE DOES NOT GUARANTEE EXHIBITORS AGAINST LOSS: NEITHER DOES IT IMPLY AN ASSUMPTION OF LIABILITY FOR EXHIBITOR'S PROPERTY BY THE CONFERENCE.

Any equipment to be removed from the exhibit area during the conference must be authorized by the Exhibit Manager in conjunction with the specific exhibitor.

9. INTERPRETATION OF RULES

Conference management shall have final authority as to the interpretation of these rules and their applications and shall have the authority to establish penalties in the event of violations.

10. AMENDMENTS TO RULES AND REGULATIONS

Conference management reserves the right to amend these rules and regulations or to make additions thereto.

11. BOOTH ASSIGNMENT PRIORITY

In the event of duplicate application for the same space, priorities will be based on the application postmark date.



Exhibitor Information

Below, please fill in the contact information you would like published on the PSCE 2006 website and in the conference program.

Contact Name & Title _____

Company Name _____

Address _____

City / State / Postal Code / Country _____

Phone _____ Fax _____

Website _____

Email _____

Company Information / Product Description:

Please indicate here that PSCE 2006 has permission to place your company's logo on the PSCE 2006 website in conjunction with your company name and other information.

Yes, you may place the company logo on the PSCE 2006 website.

No, you may not place the company logo on the PSCE 2006 website.

Please return form to:

PSCE 2006 Exhibits
Conference Management Services, Inc.
Attn: Christopher Garza
3833 Texas Avenue South, Suite 221
Bryan, Texas 77802-4015 USA
(979) 846-6800 (phone)
(979) 846-6900 (fax)
exhibits@pscexpo.com



Exhibitor Badges

Please list below the names and titles of the individuals who will be working in your booth. Please provide this information with your application, if possible.

Company Name _____

Name _____

Title _____

Name _____

Title _____

Name _____

Title _____

Name _____

Title _____

Each exhibitor will be provided up to 4 complimentary Exhibit-Hall passes per paid booth for use by the Exhibitors' employees; 25% discount on additional exhibit hall passes or 25% discount for one-day conference registration are available for up to 4 additional employees.

Please return this form to:

PSCE 2006 Exhibits
Conference Management Services, Inc.
Attn: Christopher Garza
3833 Texas Avenue South, Suite 221 • Bryan, Texas 77802-4015 USA
(979) 846-6800 (phone) • (979) 846-6900 (fax)
exhibits@pscexpo.com
www.pscexpo.com



2006 IEEE PES Power Systems Conference and Exposition

Support Opportunities

Page 1 of 3

Don't Miss Your Opportunity to Become an Official PSCE Supporter

PSCE support opportunities will get your company name in front of the people that matter. Have your name or logo posted on the PSCE website from *now* right up to the time of the conference, on signs and in the printed program at the event, and announced at conference functions. ***Be sure to select your opportunity early to ensure your company's participation!***

Recognition at the conference will take the form of a listing and company name or logo in the conference program and on conference signage. Recognition on the website will take the form of the company name or logo and a link to your company's website. Recognition at specific events and functions will take the form of an announcement at the event, as well as a listing and company name or logo in the conference program and on the conference signage.

Some of the possible individual events or support items are listed below. Other support items may be custom-tailored to your needs. Contact **Conference Management Services, Inc.** for more detail and to sign up for PSCE Support at the contact information listed at the end of this Support Opportunities description.

Platinum Conference Support - \$20,000 USD

Benefits include: 2 booths in the exhibit hall; recognition at all of the conference and exposition events listed below; recognition on the website and at the conference, and privileges associated with Exhibit Booths listed in the Exhibitor Prospectus.

Gold Conference Support - \$10,000 USD

Benefits include: 1 booth in the exhibit hall; recognition at all of the conference and exposition events listed below; recognition on the website and at the conference, and privileges associated with Exhibit Booths listed in the Exhibitor Prospectus.

Silver Conference Support - \$5,000 USD

Benefits include: recognition at all of the events listed below; recognition on the website and at the conference.

Conference Luncheon (Tuesday)- \$25,000 USD (Up to 3 companies may combine to reach this level)

Benefits of full support include: 2 booths in the exhibit hall; recognition on the website, at the luncheon and at the conference, and privileges associated with Exhibit Booths listed in the Exhibitor Prospectus. Benefits of one-half support, same as above with one booth; benefits of one-third support, same as above with no booth.

Hosted by





2006 IEEE PES Power Systems Conference and Exposition

Support Opportunities

Page 2 of 3

Don't Miss Your Opportunity to Become an Official PSCE Supporter

Conference Audio/Visual Support- \$9,500 USD per day (3 opportunities - Monday, Tuesday and Wednesday)
Benefits include: 1 booth in the exhibit hall; recognition on the website and at the conference, and privileges associated with Exhibit Booths listed in the Exhibitor Prospectus.

Welcome Reception (Sunday) - Thank You Georgia Power
Benefits of full support include: 2 booths in the exhibit hall; recognition on the website, at the reception and at the conference, and privileges associated with Exhibit Booths listed in the Exhibitor Prospectus. Benefits of one-half support, same as above with one booth; benefits of one-third support, same as above with no booth.

Conference Bags - Thank You Georgia Power
Benefits include: 2 booths in the exhibit hall; recognition on the website and at the conference, and privileges associated with Exhibit Booths listed in the Exhibitor Prospectus.

Internet Café - \$5,000 USD (3 opportunities - Monday, Tuesday and Wednesday)
Benefits include: recognition on the website, in the café and at the conference.

Speaker's Breakfast - \$4,000 USD each (2 opportunities - Tuesday and Wednesday Morning)
Benefits include: recognition on the website, at the supported breakfast and at the conference.

Reception (Monday) - \$25,000 USD (Up to 3 companies may combine to reach this level)
Benefits of full support include: 2 booths in the exhibit hall; recognition on the website, at the reception and at the conference, and privileges associated with Exhibit Booths listed in the Exhibitor Prospectus. Benefits of one-half support, same as above with one booth; benefits of one-third support, same as above with no booth.

Conference Attendee Breakfast - \$5,000 USD each (Monday, Tuesday and Wednesday Mornings)
Benefits include: recognition on the website, at the supported break and at the conference.

Conference Breaks - \$3,500 USD each (Monday Afternoon, Tuesday and Wednesday Morning and Afternoon)
Benefits include: recognition on the website, at the supported break and at the conference.

Lanyards / Badge Holders - Thank You Georgia Power
Benefits include: recognition on the website and at the conference.

Hosted by





2006 IEEE PES Power Systems Conference and Exposition

Support Opportunities

Page 3 of 3

Don't Miss Your Opportunity to Become an Official PSCE Supporter

Companions' Room - Thank You Georgia Power

Benefits include: recognition on the website, at the conference, and in the companions' room.

Companions' Bags - Thank You Georgia Power

Benefits include: recognition on the website, at the conference, in the companions' room, and on the bag.

Technical Tour Transportation - \$1,500 USD (Multiple opportunities)

Benefits include: recognition on the website, at the conference, and for the Tour Transportation.

Companion/Social Tour Transportation - \$1,000 USD (Multiple opportunities)

Benefits include: recognition on the website, at the conference, and for the Tour Transportation.

Student Luncheon - Support of Students at \$100 USD each or \$1000 USD per table (Multiple opportunities)

Benefits include: recognition on the website, at the luncheon, and at the conference.

Conference and Companion Bag Giveaways - \$750 USD plus 1500 quantity of give-away item with your company's logo (e.g., pens, pads, sticky notes, stress balls, key chains, luggage tags, mugs, caps, clocks, calculators, etc.)

Benefits include: recognition on the website and at the conference, inclusion of give-away in the conference and companion bags. (Note: Giveaways are subject to Organizing Committee review and approval.)

NOTE: Participate early to ensure availability of premium booths!

Please contact:

PSCE 2006 Exhibits • Conference Management Services, Inc.
3833 Texas Avenue South, Suite 221 • Bryan, Texas 77802-4015 USA
(979) 846-6800 (phone) • (979) 846-6900 (fax) • exhibits@pscexpo.com

www.pscexpo.com

Hosted by





Support Agreement

The full payment of the conference support accompanies this application. We understand that, if accepted by PSCE 2006, a written confirmation of this application will be returned to us. In the event the application is denied, PSCE 2006 will promptly advise us and return the deposit.

Company Name _____

Contact Name & Title _____

Address _____

City / State / Postal Code / Country _____

Phone / Fax / Email _____

CONFERENCE SUPPORT REQUESTED _____	Cost \$USD
_____	\$ _____
_____	\$ _____
_____	\$ _____
_____	\$ _____
Total Support Cost	\$ _____

Checks should be made payable to IEEE / PSCE 2006, Federal Tax ID Number 13-1656633. If you wish to pay by credit card, please fill in the information below.

Credit Card Number for Support Fees (Visa / MasterCard / AmericanExpress)

_____ Exp MM / YY _____

Amount to Charge \$USD _____ Name on Card _____

Signature _____

In acceptance of this agreement, the parties thereto affix their signature:

Company Signature _____

Title _____ Date _____

PSCE 2006 Signature _____

Title _____ Date _____

Send Agreement to:
PSCE 2006 Exhibits
Conference Management Services, Inc.
 Attn: Christopher Garza
 3833 Texas Avenue South, Suite 221
 Bryan, Texas 77802-4015 USA
 (979) 846-6800 (phone)
 (979) 846-6900 (fax)
 exhibits@pscexpo.com
 www.pscexpo.com